

Economic Development, Transport and Climate Emergency Scrutiny Commission

23rd March 2022



Connecting Leicester Transforming Cities Fund updates

1. A50
2. Beaumont Leys Park and Ride
3. Great Central Way

A50 Scheme – Fosse Road North/FiveWays junction/ Woodgate/ Northgate Street/Great Central Street

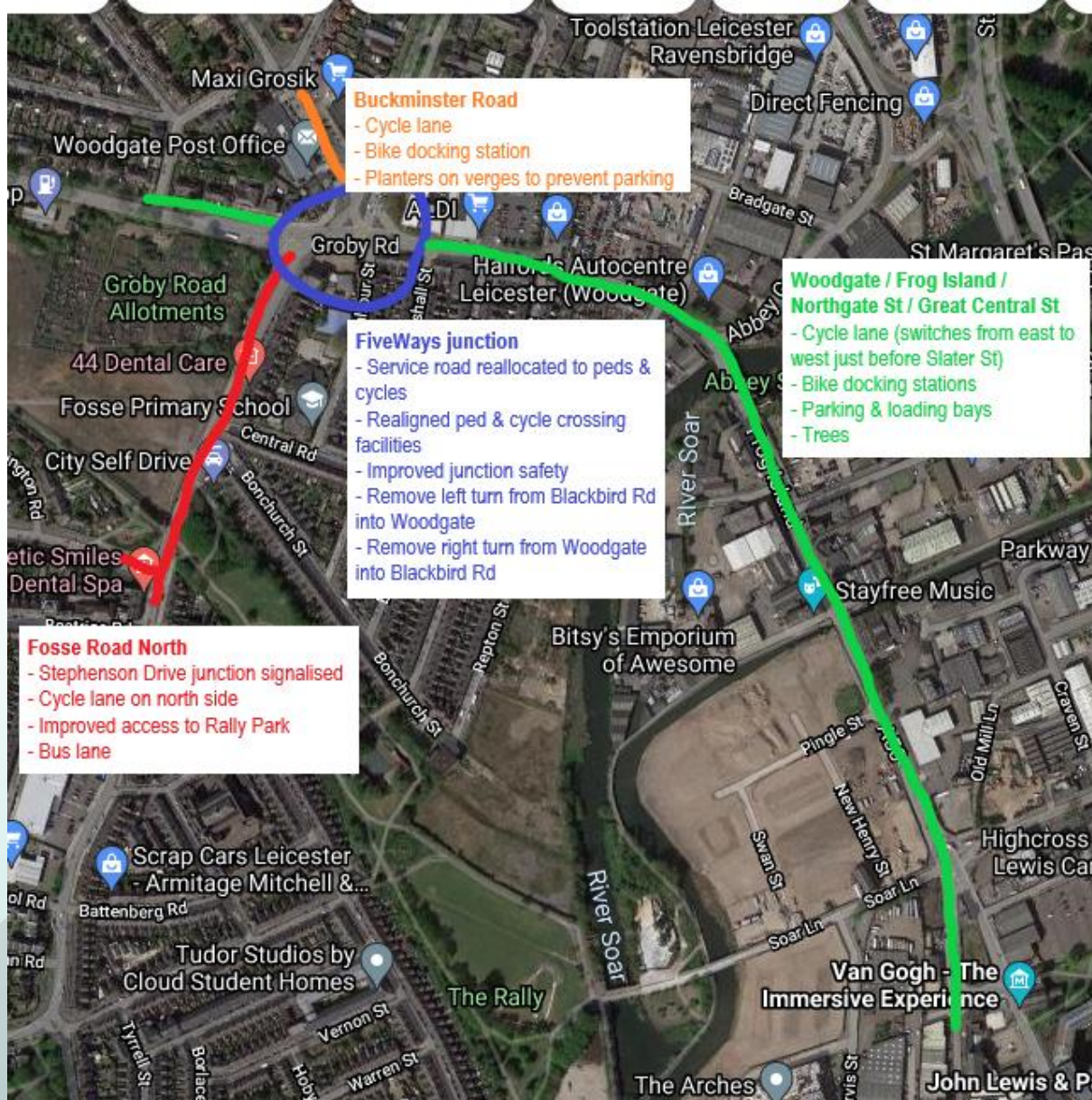

A50 Scheme – Fosse Road North/FiveWays junction/Woodgate/Northgates/Great Central Street

Scheme Objectives:

- To reroute and downgrade the A50 through Woodgate so that through traffic is diverted away from the Waterside
- To improve walking, cycling and public transport facilities and to encourage more use of sustainable transport modes by the following:
 - Introduce cycling infrastructure along Fosse Road with cycle friendly access to Rally Park, cycling provision at the FiveWays junction and cycling infrastructure along Woodgate to meet up with Great Central Street;
 - Introduce a bus lane on Fosse Road North, and bus priority at the FiveWays junction for buses using Fosse Road North and Groby Road;
 - Realign and relocate where necessary pedestrian crossings to improve walking facilities and introduce benches where possible
- To improve safety at the FiveWays junction by removing the internal stop lines and altering the junction alignment slightly
- To alleviate flooding at the FiveWays junction - looking at drainage and introducing more trees and improved drainage methods



Fosse Road North (Stephenson Drive to FiveWays junction)

- Signalised T junction at Stephenson Drive
- New segregated 3m cycle lane along northern footpath (requires 4m strip of land from school site – with Legal)
- New offside bus lane, approx. 150-200m in length
- Bus stop removed on northern side just before FiveWays
- Improved cycle access to Rally Park

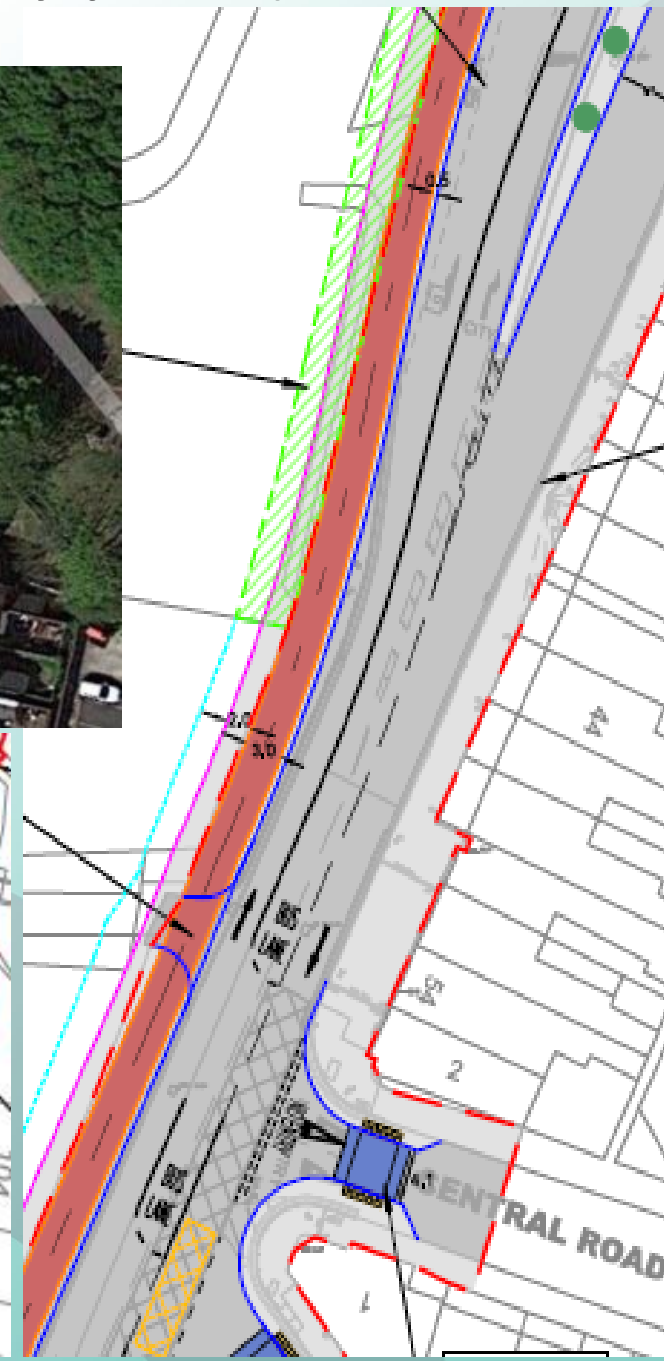

FiveWays Junction (including Buckminster Road junction)

- Service road to be reallocated to cyclists & pedestrians, retaining access to Doctors surgery
- New realigned crossing facilities for cyclists and pedestrians
- Removal of left turn from Blackbird Road into Woodgate
- Narrowing of entrance/exit to Woodgate
- Removal of right turn from Woodgate into Blackbird Road/Buckminster Road
- Removal of stop lines from centre of junction to improve safety
- Relocate bus stop on Groby Road to just before Medina Road to allow buses to access centre lane
- New planters, railings etc to prevent parking on raised verges on Buckminster road
- Alterations to Buckminster Road junction to narrow the entrance and exit Potential locations for bike share docking station



Woodgate to Northgates

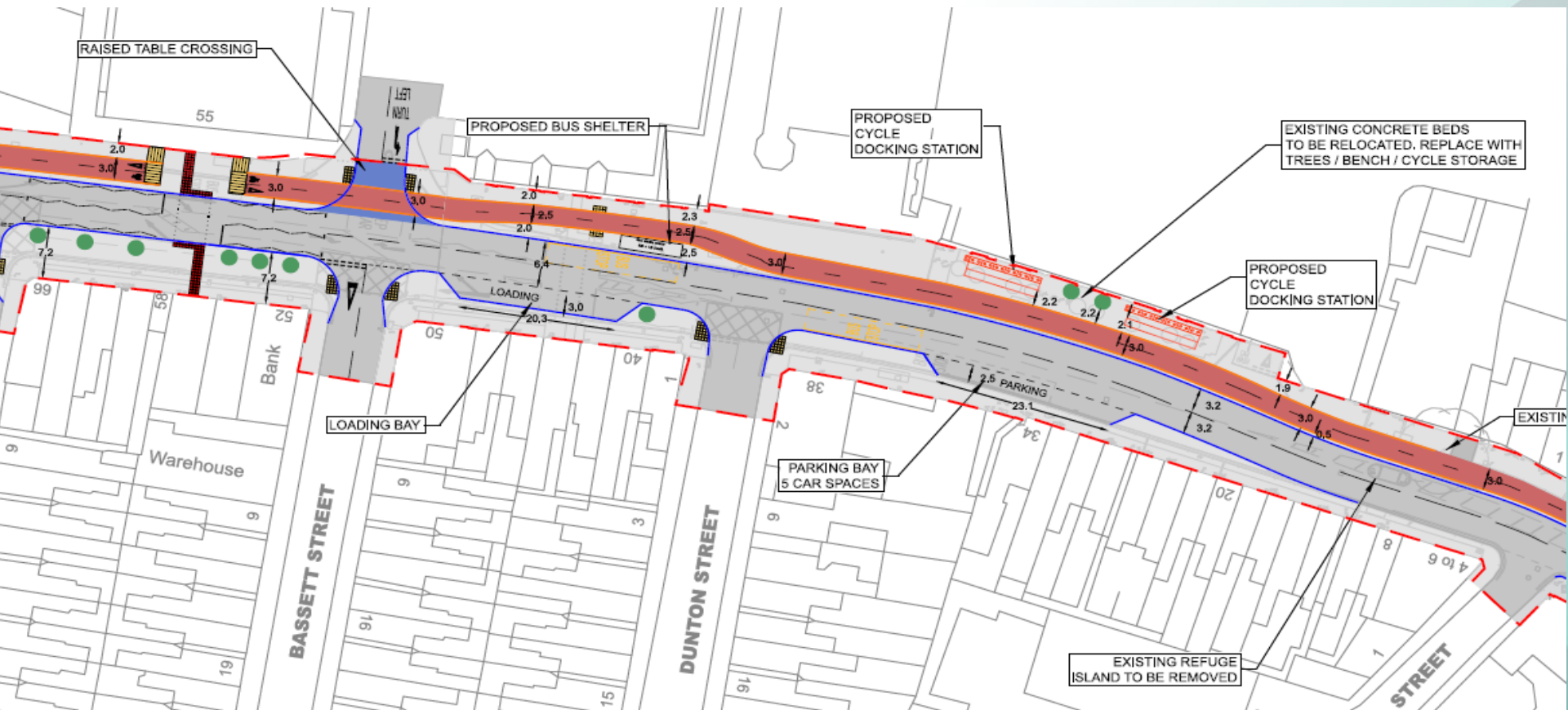

- New 3m segregated cycle lane on northern/eastern side
- Pedestrian crossing on Northgates relocated to just north of Slater Street
- Introduction of parking bays and loading bays on southern side
- Relocation of bus stop and pedestrian crossing close to the Aldi supermarket – swapped over
- Removal of Woodgate concrete planters to be replaced with trees/benches/cycle parking or docking station



Next steps

- Public engagement – Spring 2022
- Complete detailed design
- On site Autumn 2022
- Construction completion Summer 2023

Beaumont Leys Park and Ride

The objective of this scheme is to provide better accessibility to the City Centre and the hospital and reduce car congestion along Anstey Lane and emissions on key radial routes

The new Park and Ride Site will:

- Service existing commercial services to the City Centre reducing congestion and emissions in the City
- Provide park and ride bus connectivity to the Glenfield Hospital to help relieve congestion on the A50/A46 and Outer Ring Road

Beaumont Leys Park and Ride

- New 250 - 300 space Park and Ride site
- EV Charging provision (exact number TBC)
- Cycle Hub
- Bus Shelter
- Barriers and ticketing system

- Internal bus-only entrance/exit road
- SuDs-compliant drainage and biodiversity offsetting

- Accommodating bus services 40, 54, 74, and the UHL Hopper



Beaumont Leys Park and Ride – Stage 3 Proposals

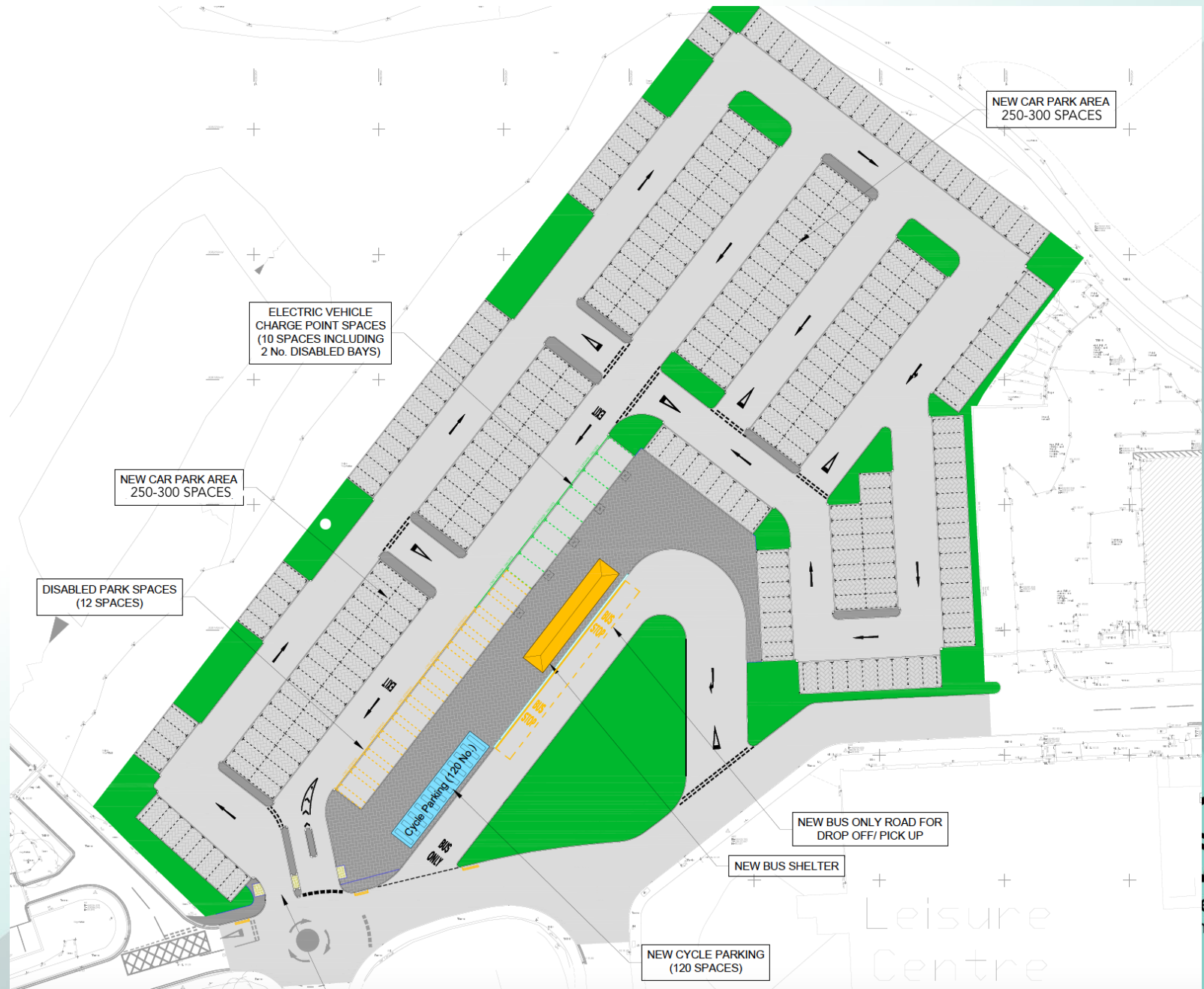



Example of
cycle hub



Beaumont Leys Park and Ride – Next steps

- Detailed Design complete, May 22
- Planning Submission, Spring 22
- Public engagement, Spring 22
- TCF Approval Board, Summer 22
- Start on Site, Summer 22 (9-12 month programme)

Great Central Way Overview

The objective of this scheme is to provide a new key strategic walking and cycling route from New Lubbethorpe and Meridian leisure park to Leicester city centre, enhancing sustainable transport links for pedestrians and cyclists.

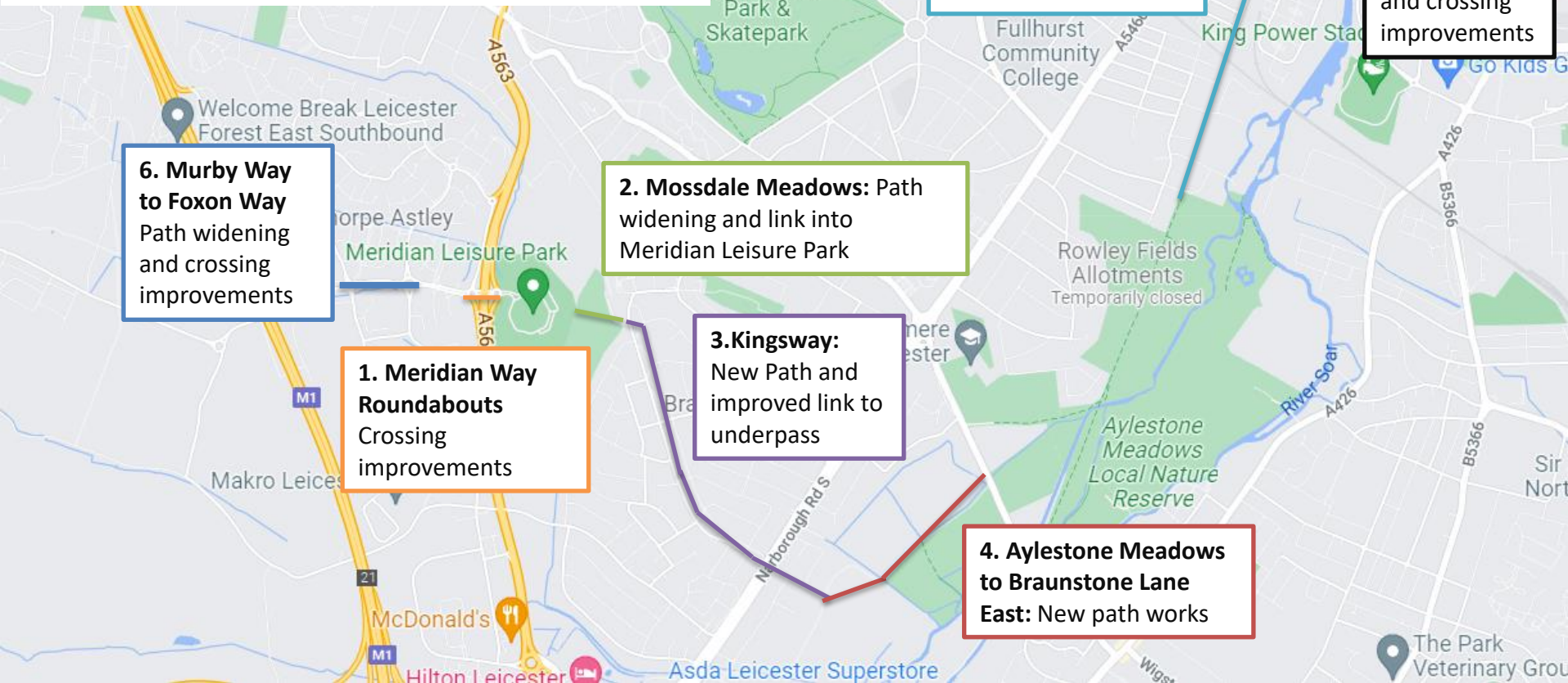

Murby Way to Foxon Way

- Option 1- Widening of the existing path between Murby Way and Foxon Way from 1.5m to 3m to match existing widths of surrounding paths.
- Option 2- Improvements to be made over the north arms of the 2 roundabouts at Murby Way and Foxon Way, with crossing distances reduced by extending the kerbs out and extending central islands into the carriageway.
- Black top surfacing to be used for the works as per existing

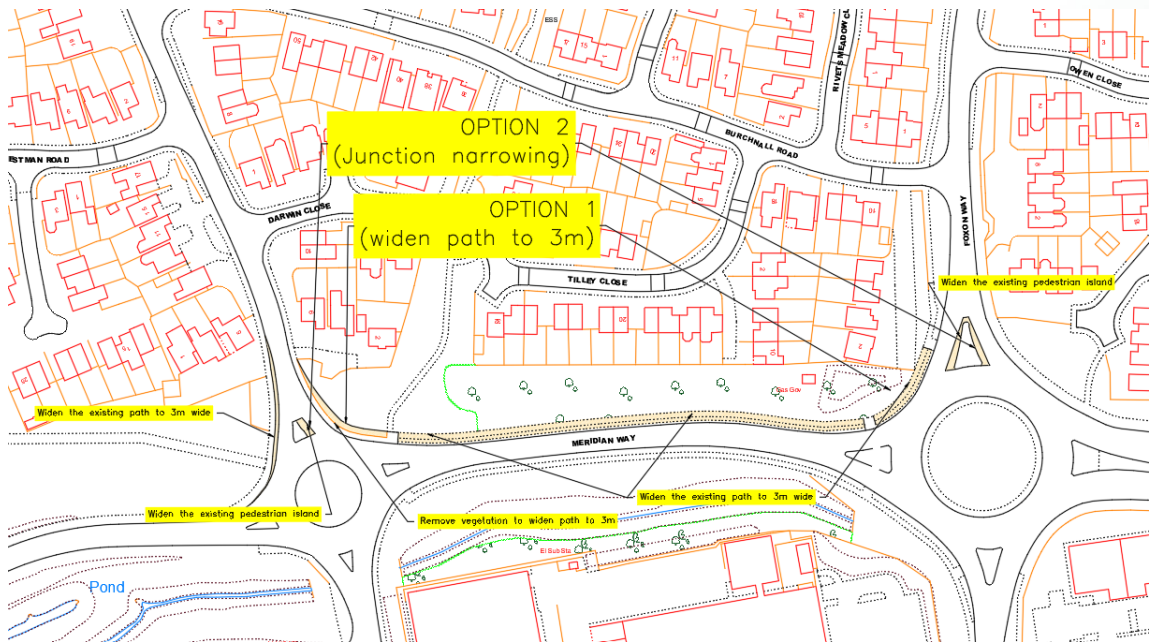

Meridian Way Roundabouts

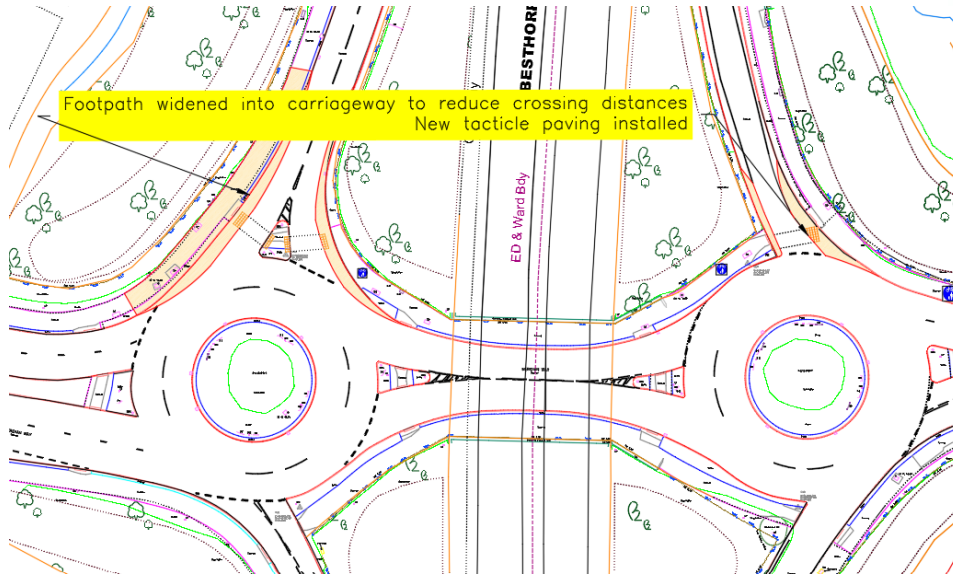

- Improvements to be made over the north arms of the 2 roundabouts over Lubbethorpe Way connecting New Lubbethorpe and Meridian Leisure park.
- Crossing distance will be reduced by extending the kerbs out into the carriageway. The poor visibility will also be improved.
- Black top surfacing to be used for the works



Mossdale Meadows

- Existing path through Mossdale Meadows to be widened from 1.5m to 3m, along with additional lighting to be installed to create a more attractive and safer environment for all users.
- Meridian Leisure Park to create an access between Chiquito restaurant and Vue cinema to allow users to have a connected route from New Lubbethorpe to Braunstone and beyond.
- Blacktop to be used to match existing

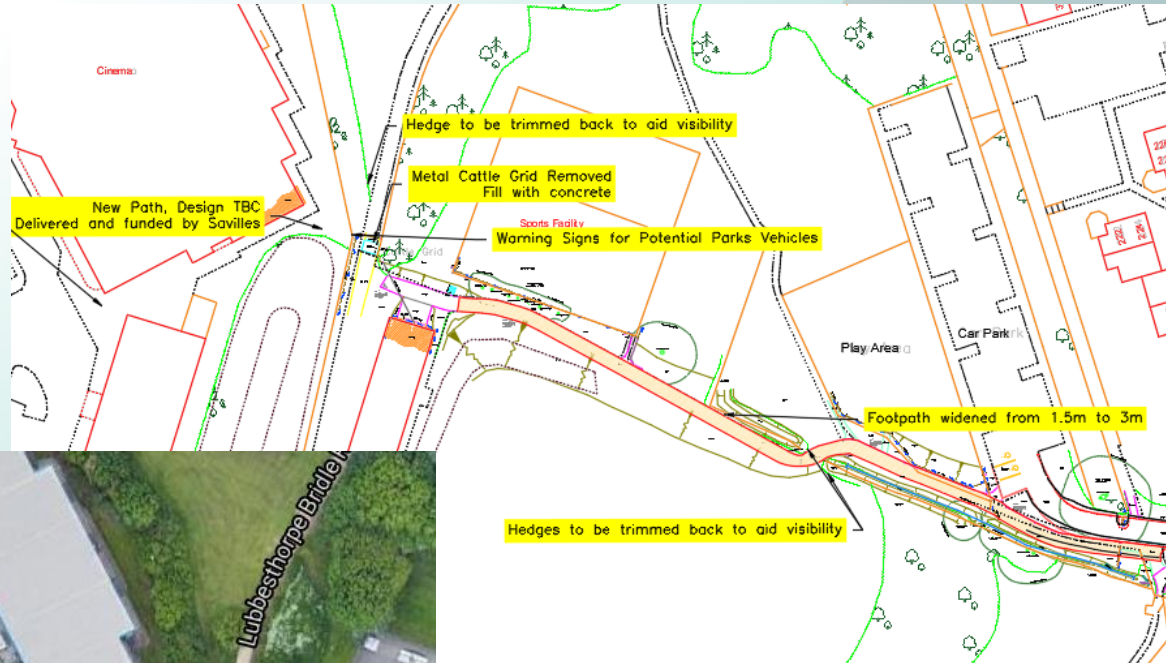

New access between Vue cinema and Chiquitos restaurant provided by Savilles



Aylestone Meadows to Braunstone Lane East

- Existing path from Braunstone Lane East to Aylestone Meadows to be resurfaced to create improved and safer surface for users. Potential for solar studs (as used at Ellis Meadows and Loughborough Road) to be used along pathways as users enter Local Wildlife Site.
- New path to be created across the attached park, along with existing board walk to be widened to make it easier for users to access the route
- Different surfacing options to be looked at. Potential Breedon gravel type material to be used through park, and Blacktop or Breedon gravel for main footpath dependant on expected vehicular usage

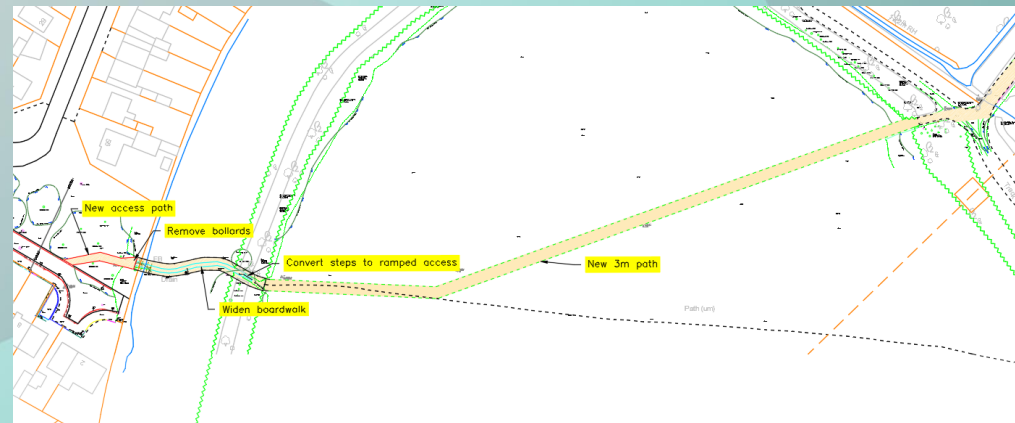

Mill Lane



Provides a key walking & cycling link to the Braunstone Gate, which is being developed into a mini Holland scheme.

- Design includes making the temporary pop up cycle lane scheme on Western Boulevard permanent
- Provide uni-directional cycle facilities along Mill Lane on carriageway level with armadillo separators
- Potential to remove signals and replace with zebra crossings subject to approval

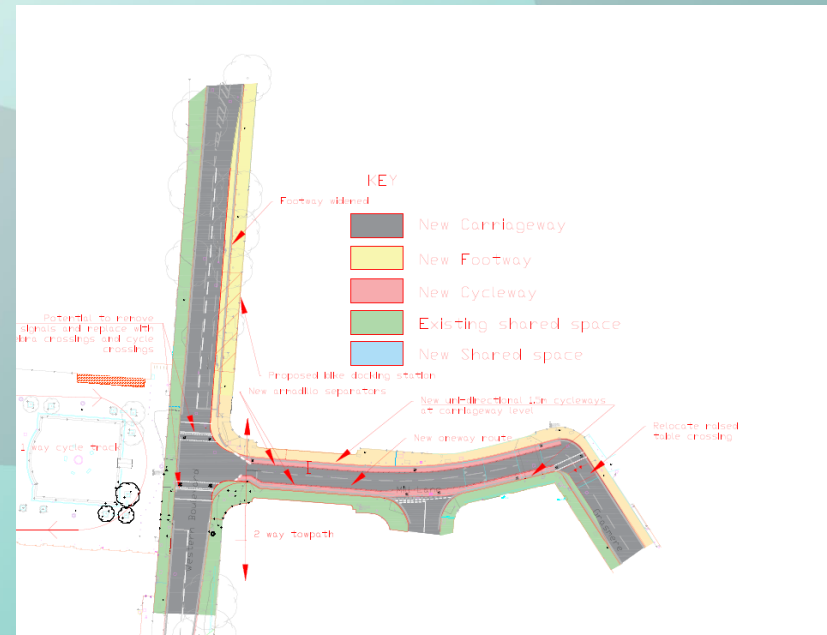

Programme Of Works

- Contractor (City Highways) due to start on site May 22.
- The proposed sequencing of works is
 - Mill Lane
 - Kingsway – new path
 - Meridian roundabouts
 - Mossdale Meadows (subject to planning consent)
 - Aylestone Meadows, subject to Sustrans funding being confirmed.

Next Steps

- Applied for additional funding from Sustrans funding decision expected late March
- Public engagement to commence March
- PTV Vissim modelling for Meridian Roundabouts
- Finalise Mill Lane design and prepare work packages for contractor
- Process planning application for Mossdale Meadows